

## Humanetics Innovative Solutions, Inc.

Q1 Child Dummy  
(Advanced 1 year old child)  
036-0000



Parts Catalog





For information on Humanetics products, please visit our web site at [www.humaneticsatd.com](http://www.humaneticsatd.com)

or contact:

Humanetics Innovative Solutions  
47460 Galleon Drive  
Plymouth, MI 48170, USA  
Telephone: 734-451-7878  
Fax: 734-451-9549

No part of this publication may be reproduced, stored in a retrieval system or transmitted in any form or by any means, electronic, photocopying, recording, mechanical or otherwise, without the express written consent of Humanetics Innovative Solutions.

Copyright © 2015 Humanetics Innovative Solutions, All rights reserved.

The information in this catalog is furnished for informational use only, and is subject to change without notice. Humanetics Innovative Solutions assumes no responsibility or liability for any errors or inaccuracies that may appear in this catalog.

## Table of Contents

Head Assembly .....	4
Neck Assembly.....	5
Torso Assembly.....	6 - 8
Lumbar Assembly .....	9
Pelvis Assembly .....	10
Arm Assembly.....	11
Leg Assembly .....	12
Accelerometer Mounts .....	13
Clothes/Misc.....	14

## Background

The Q1 advanced 1 year old child development started with the CHILD project in 2002. The prototype Q1 dummy became available for evaluation testing in the CHILD-project in 2003. Results of the first evaluations have been published and the 19th Enhanced Safety of Vehicles conference in 2005. In 2004 the design was frozen, and since then the dummy has been commercially available.

### Head Assembly

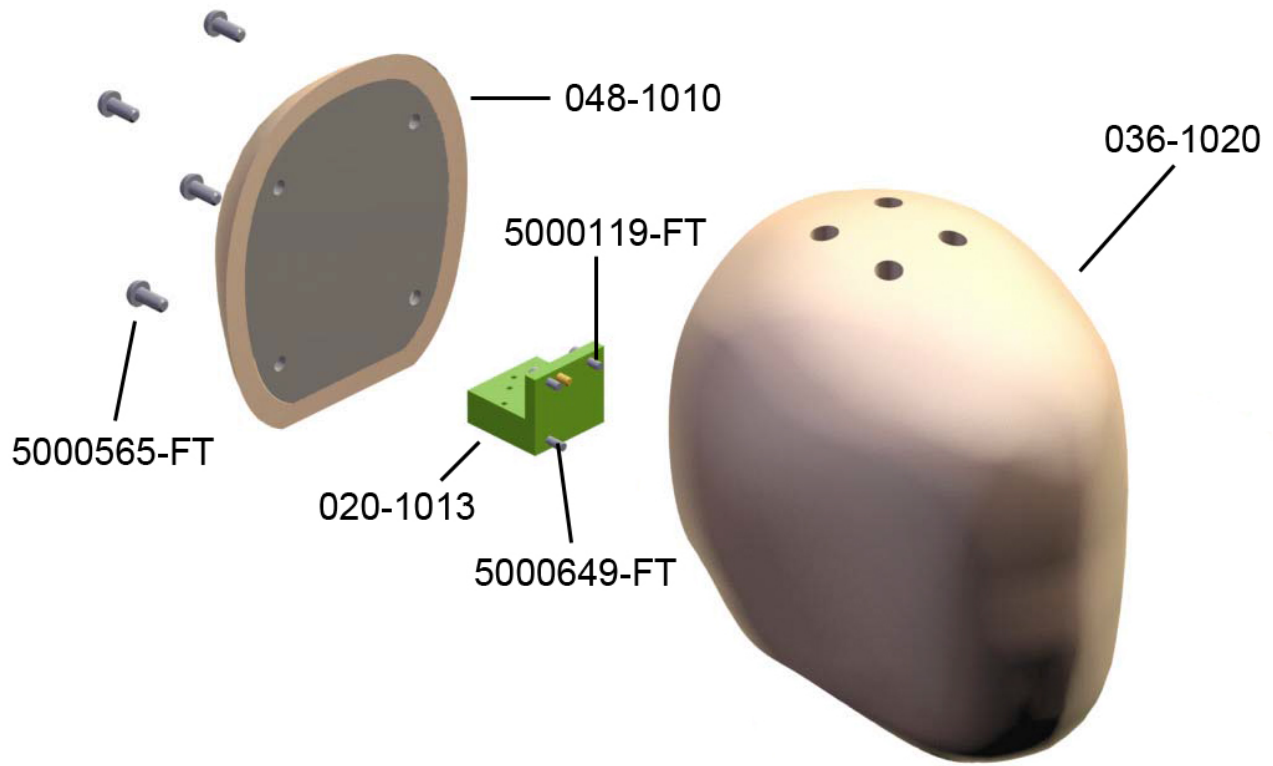

Part Number	Description	Qty. Req'd Per Dummy
<b>036-1000</b>	<b>HEAD ASSY Q1 T/C</b>	<b>1</b>
036-1020	HEAD FRONT ASSY Q1 T/C	1
048-1010	HEAD REAR CAP ASSEMBLY	1
020-1013	BRACKET ASSY, HEAD ACCEL MOUNT	1
5000565-FT	SCREW BHCS M5 X 0.8 X 12 18-8 SS	4
5000649-FT	SCREW SHCS M3 X 0.5 X 40	1
5000119-FT	SCREW SHCS M3 X 0.5 X 10	2

### Neck Assembly

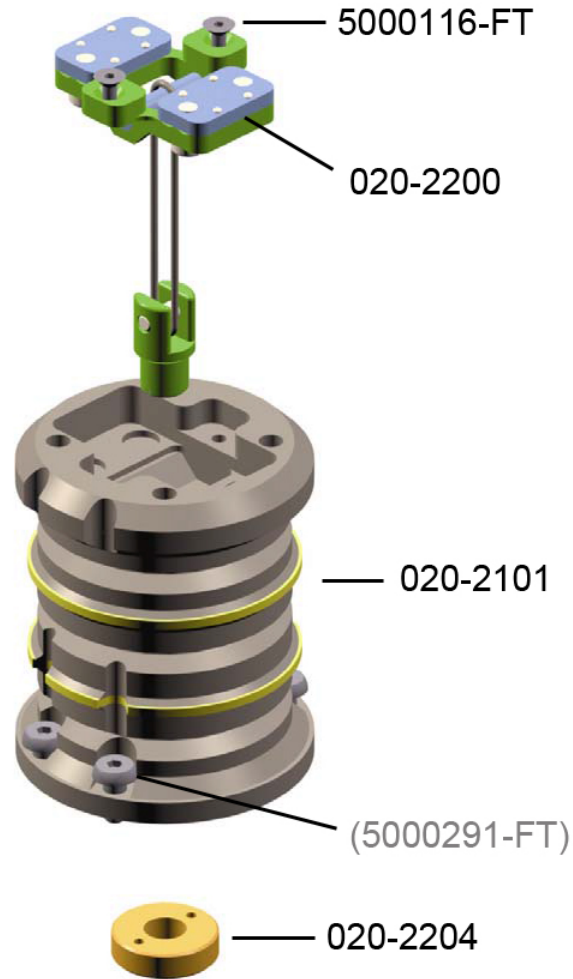

<i>Part Number</i>	<i>Description</i>	<i>Qty. Req'd Per Dummy</i>
<b>020-2100</b>	<b>NECK ASSY W/CBL, TEST/CERT, Q3</b>	<b>1</b>
020-2101	NECK CENTRAL MOLDING, T/C Q3	1
020-2200	NECK CABLE ASSY, Q3	1
020-2204	NUT (Included in cable assy)	1
5000116-FT	SCREW FHCS M3 X 0.5 X 8	2
(5000291-FT)	SCREW SHCS M5 X 0.8 X 10	4

### Torso Assembly

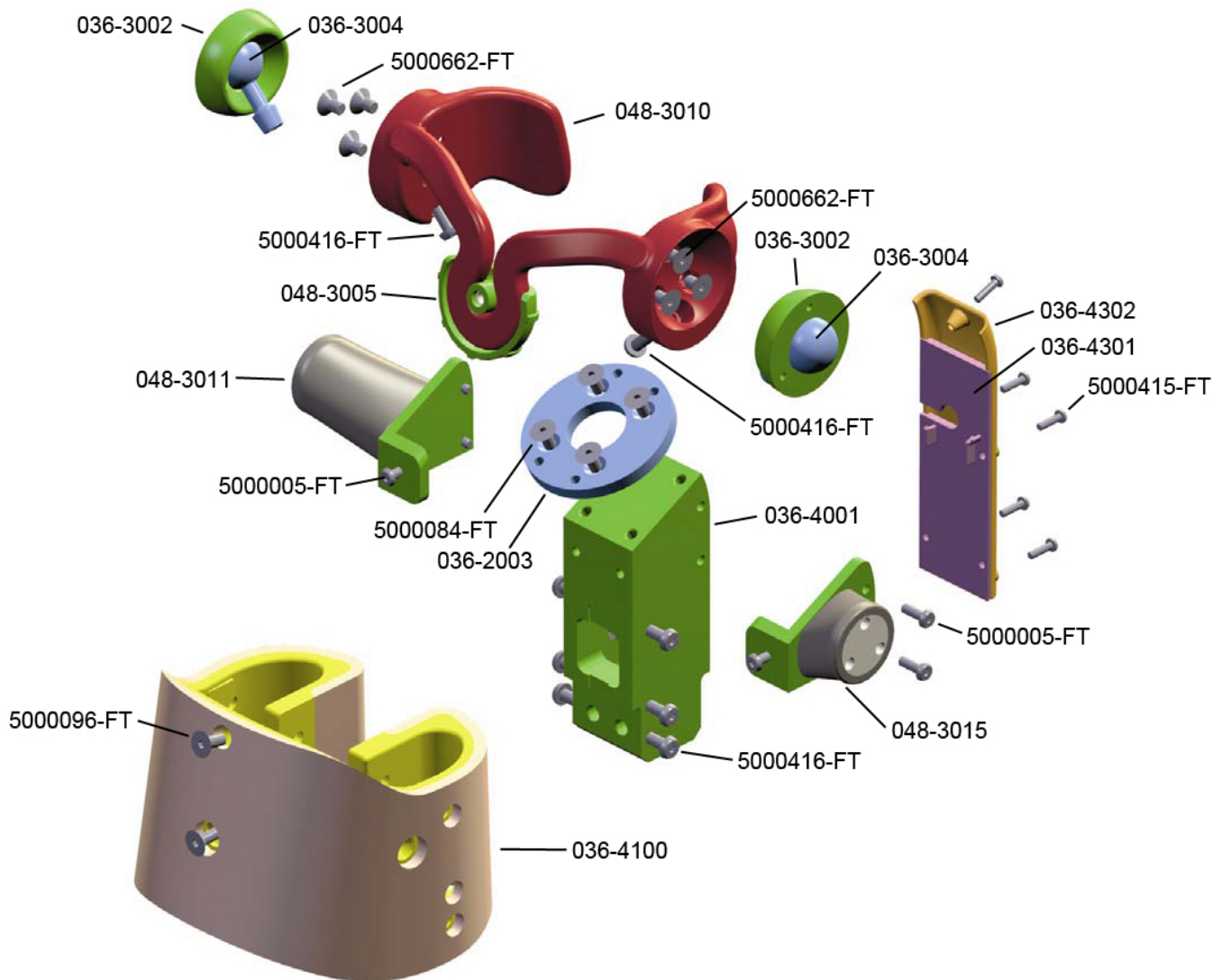

Part Number	Description	Qty. Req'd Per Dummy
<b>036-4000</b>	<b>TORSO ASSY Q1 T/C</b>	<b>1</b>
036-4001	THORACIC SPINE	1
048-3011	SHOULDER SPINE INTERFACE RIGHT (RUBBER)	1
048-3015	INTERFACE ASSY, SHOULDER SPINE, L	1
5000005-FT	SCREW BHCS M4 X 0.7 X 12	6
048-3010	CLAVICLE MOULDING	1
5000662-FT	SCREW FHCS M5 X 0.8 X 8 18-8 SS	6
036-3004	SHOULDER BALL	2
036-3002	SHOULDER BALL RETAINING RING	2
036-3005	SHOULDER FRICTION WASHER	6

036-3006	SHOULDER WASHER	6
5000416-FT	SCREW BHCS M5 X 0.8 X 16	8
036-4100	RIB CAGE ASSY Q1 - T/C	1
048-3005	CLAVICLE RETAINER	1
036-2003	NECK TORSO INTERFACE PLATE	1
5000084-FT	SCREW FHCS M5 X 0.8 X 10	8
5000291-FT	SCREW SHCS M5 X 0.8 X 10	8

**Torso Assembly (Con't)**

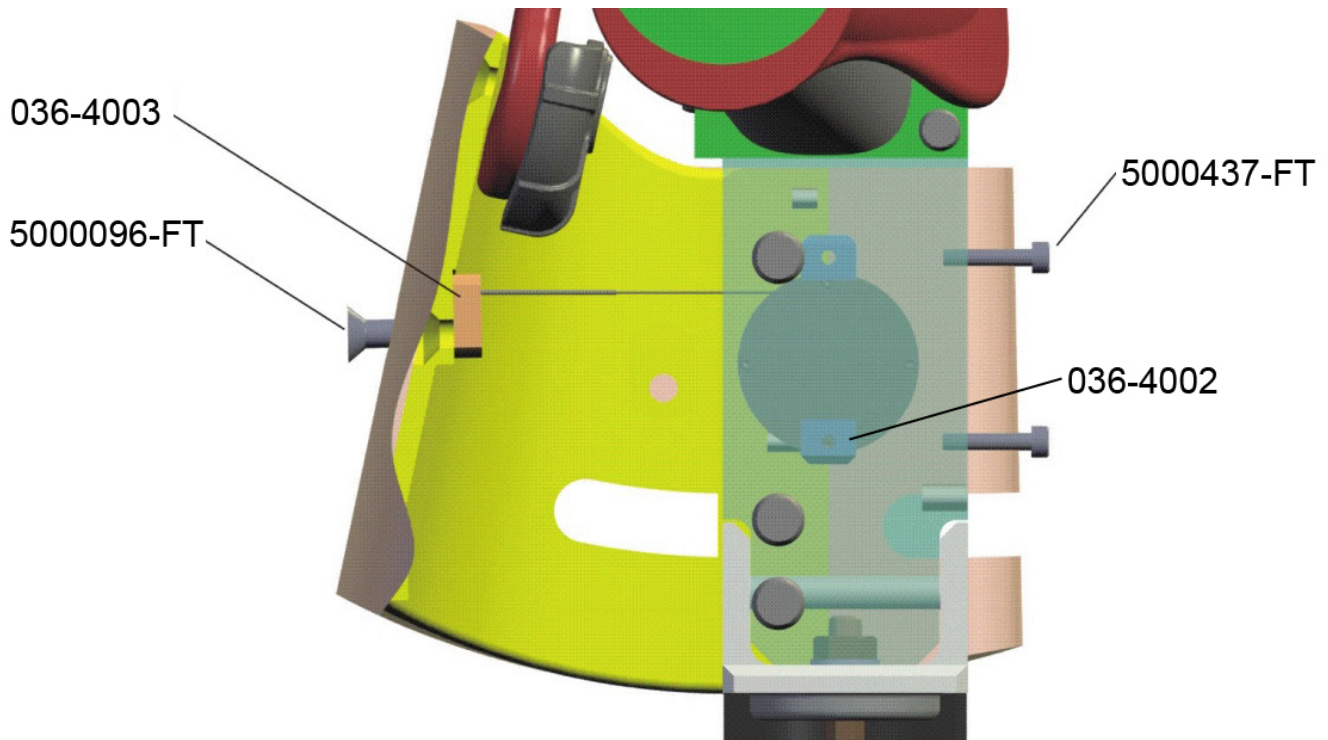

<i>Part Number</i>	<i>Description</i>	<i>Qty. Req'd Per Dummy</i>
<b>036-4000</b>	<b>TORSO ASSY Q1 T/C (Con't)</b>	<b>1</b>
036-4003	STRING POT MOUNT	1
5000096-FT	SCREW FHCS M5 X 0.8 X 12	2
036-4002	STRING POT CADDY	1
5000437-FT	SCREW SHCS M3 X 0.5 X 16	2
Side String Pot Mounting (Not shown)		
036-4302	CABLE TRAY OUTER	1
036-4301	CABLE GUIDE OUTER	1
5000415-FT	SCREW BHCS M3 X 0.5 X 12	4
048-3103	SIDE STRING POT CADDY Q1.5	1
9010511-DN	SCREW, SHCS M3 X 0.5 X 14	6



**Lumbar and Abdomen**

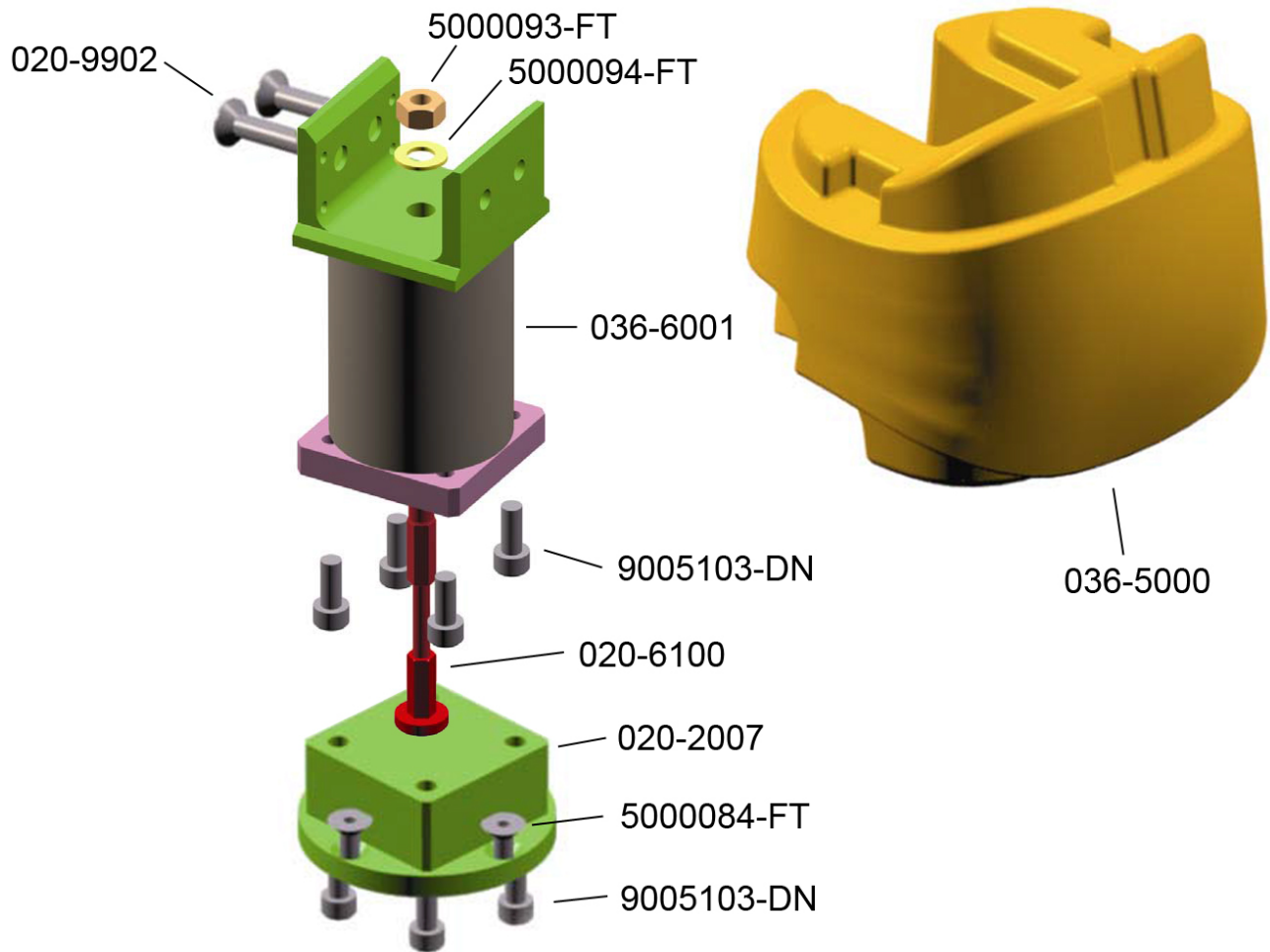

<i>Part Number</i>	<i>Description</i>	<i>Qty. Req'd Per Dummy</i>
<b>036-6000</b>	<b>LUMBAR SPINE ASSY T/C</b>	<b>1</b>
036-6001	LUMBAR SPINE MOLDED	1
020-6100	CABLE	1
5000093-FT	NUT HEX NYLON INSERT M6 X 1 ZINC	1
5000094-FT	WASHER FLAT M6 (6.7 X 12.5 X 1) SS	1
020-9902	LUMBAR SPINE MOUNTING SCREW	2
020-2007	LC STRUCTURAL REPLACEMENT (QB.CB)	1
9005103-DN	SCREW, SHCS M5 X 12	8
5000084-FT	SCREW FHCS M5 X 0.8 X 10	4
036-5000	ABDOMEN, Q1 T/C	1

**Pelvis**

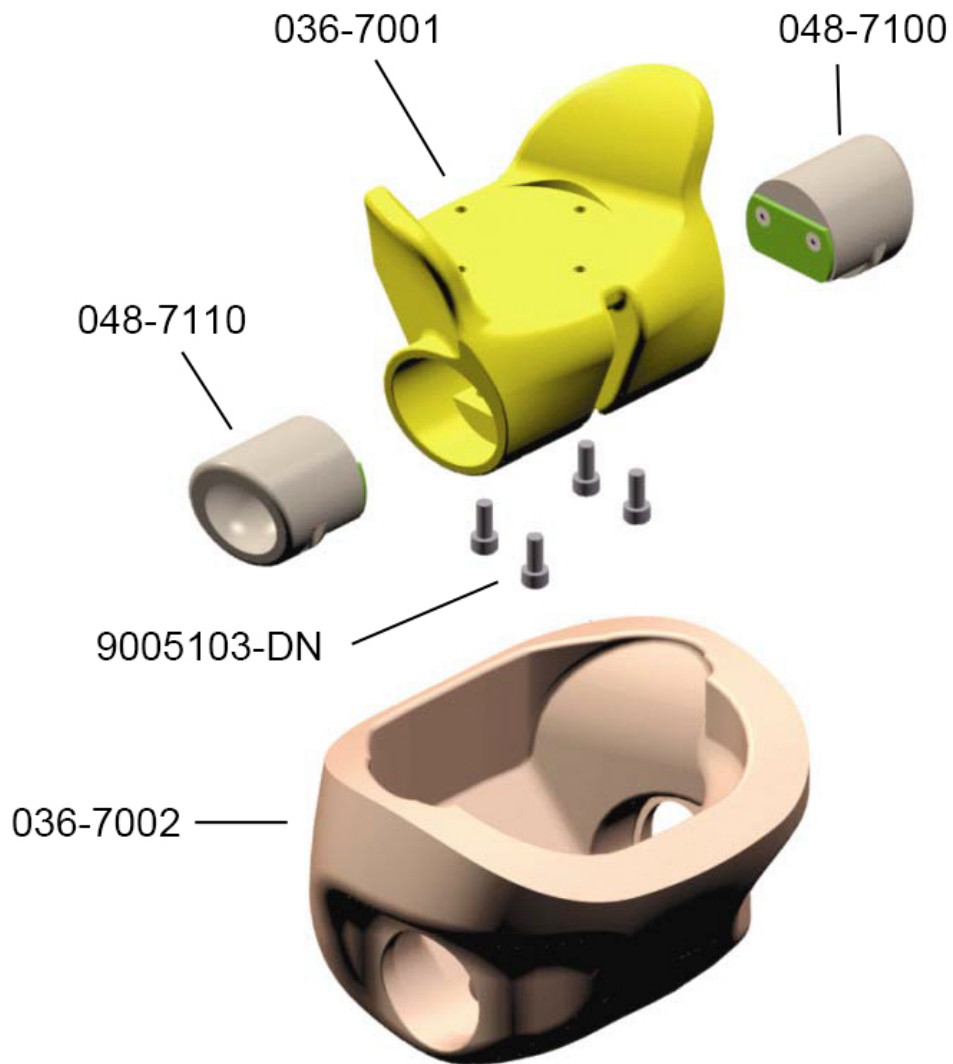

<i>Part Number</i>	<i>Description</i>	<i>Qty. Req'd Per Dummy</i>
<b>036-7000</b>	<b>PELVIS ASSEMBLY</b>	<b>1</b>
036-7001	PELVIS CASTING / BONE MACHINED	1
036-7002	PELVIS FLESH	1
048-7100	HIP JOINT ASSEMBLY, LEFT	1
048-7110	HIP JOINT ASSEMBLY RIGHT	1
9005103-DN	SCREW, SHCS M5 X 12	4

**Arms**

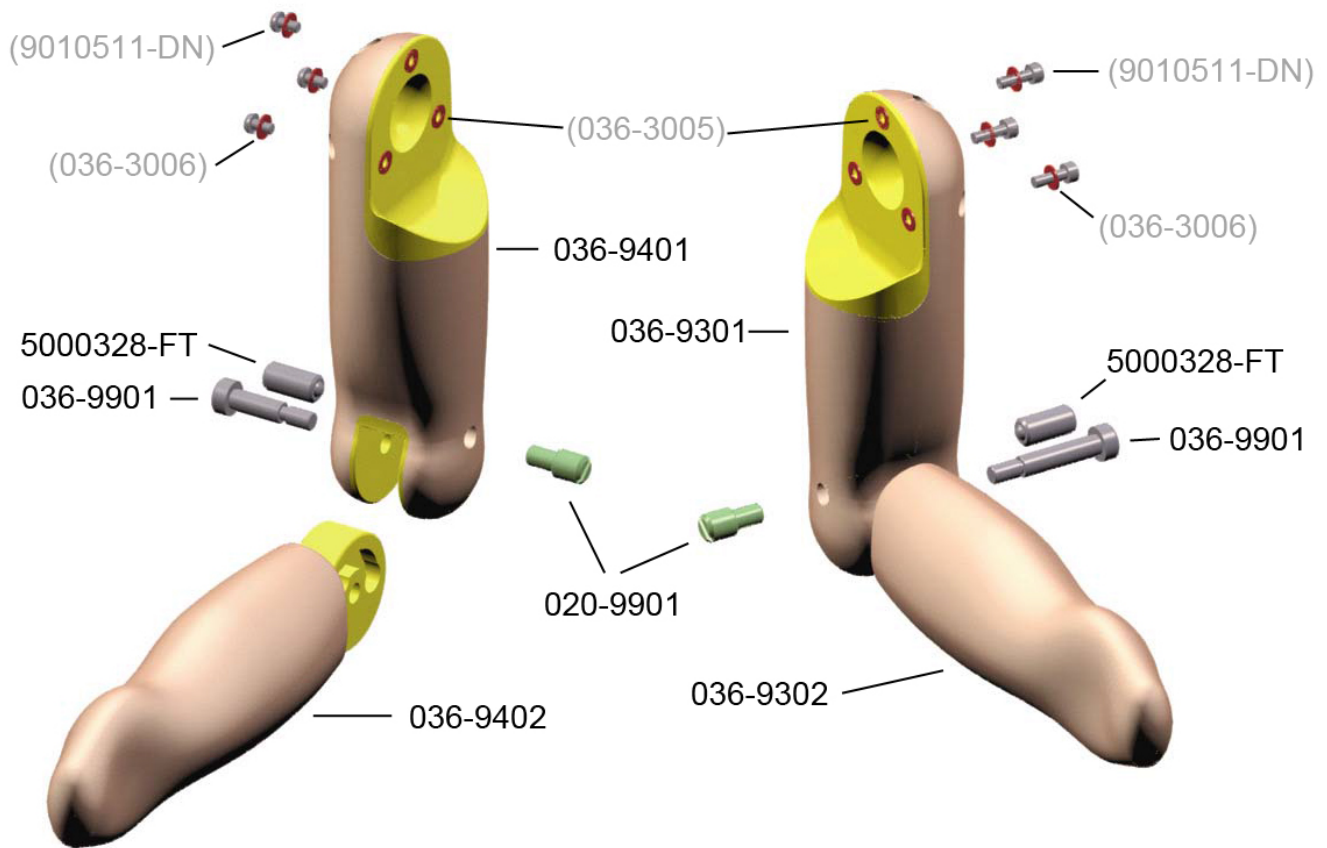

Part Number	Description	Qty. Req'd Per Dummy
<b>036-9300</b>	<b>ARM ASSEMBLY - LEFT</b>	<b>1</b>
036-9302	ARM, LOWER LEFT	1
036-9301	UPPER ARM LEFT	1
036-9901	SHOULDER BOLT MODIFIED Q1/Q1.5	1
5000328-FT	SPRING PLUNGER M8	1
020-9901	STOP SCREW	1
<b>036-9400</b>	<b>ARM ASSEMBLY - RIGHT</b>	<b>1</b>
036-9402	ARM, LOWER RIGHT	1
036-9401	ARM, UPPER RIGHT	1
036-9901	SHOULDER BOLT MODIFIED Q1/Q1.5	1
5000328-FT	SPRING PLUNGER M8	1
020-9901	STOP SCREW	1
(036-3005)	SHOULDER FRICTION WASHER	3
(9010511-DN)	SCREW SHCS M3 X 0.5 X 14	6
(036-3006)	SHOULDER WASHER	6

**Legs**

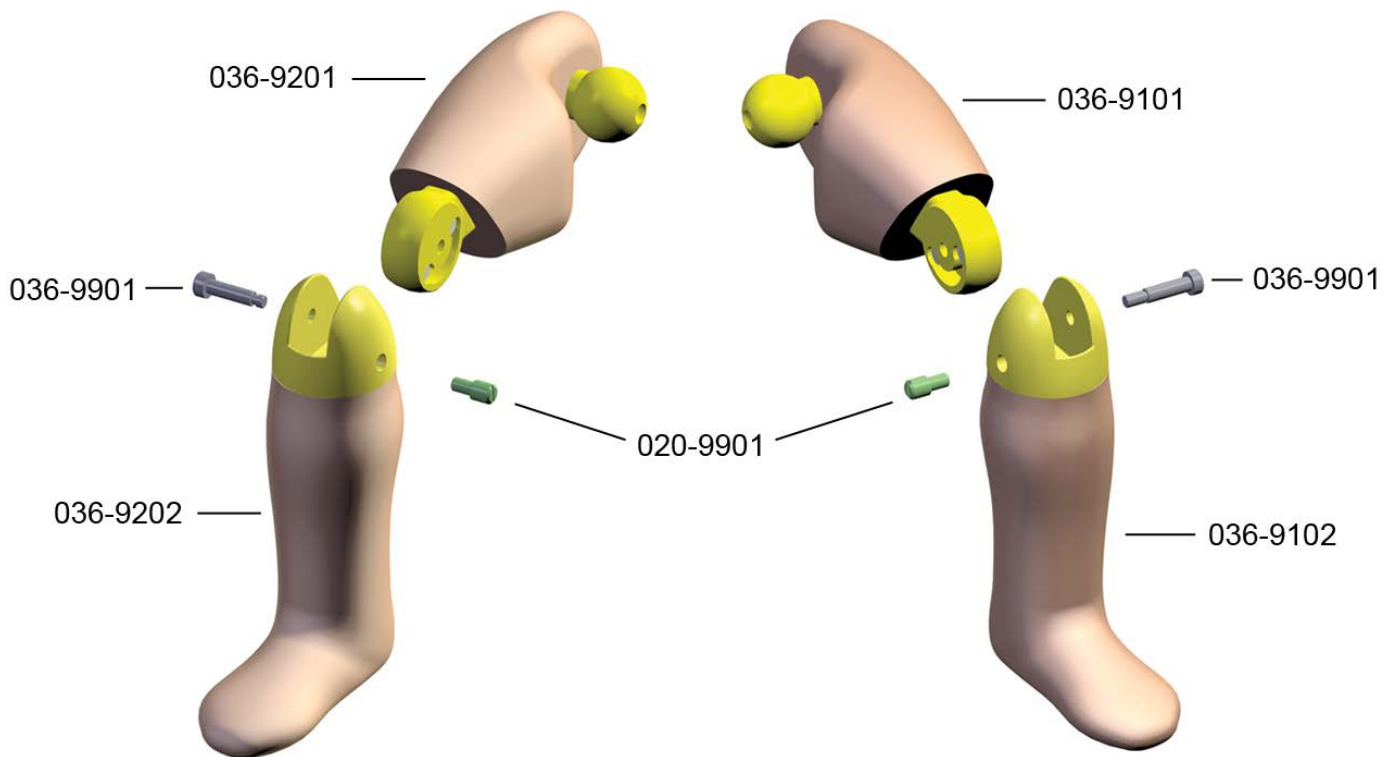

<i>Part Number</i>	<i>Description</i>	<i>Qty. Req'd Per Dummy</i>
<b>036-9100</b>	<b>LEG ASSEMBLY - LEFT</b>	<b>1</b>
036-9101	LEG, LEFT UPPER	1
036-9102	LEG, LOWER LEFT	1
036-9901	SHOULDER BOLT MODIFIED Q1/Q1.5	1
020-9901	STOP SCREW	1
<b>036-9200</b>	<b>LEG ASSEMBLY - RIGHT</b>	<b>1</b>
036-9201	LEG, UPPER RIGHT	1
036-9202	LEG, LOWER RIGHT	1
036-9901	SHOULDER BOLT MODIFIED Q1/Q1.5	1
020-9901	STOP SCREW	1

## Accelerometer Mounts

### Mount Kits

Accelerometer Type	Complete Dummy	Components		
		Head	Thorax	Pelvis
<b>Endevco</b> 7264-2000 7264C-2000	<b>1032448</b>	1032470	1032471	1032471
7264A 7264B EGAS-FS-50	<b>1032449</b>	1032469	1032472	1032472
7264 7264C ASM-200BA 126M/CM (qty 3) & DTS ARS Sensor Series in the head	<b>1032506</b>	1032489	1032471	1032471
7264A 7264B EGAS-FS-50 (qty 3) & DTS ARS Sensor Series (qty 3) in the head	<b>1032538</b>	1032488	1032472	1032472
7264 7264C ATA ARS-06S (qty 3) in head	<b>1032541</b>	1032490	1032471	1032471

### Uni-axial: (Mount Reference)

Accelerometer Type	Location					
	Head mount (only Uni-axial accels)	Head Mount for uni-accel & DTS ARS sensor (Optional)	Head Mount for ATA ARS-06S sensor (optional)	Head Mount for Uni-accel & ATA ARS-06S sensor (optional)	Thorax	Pelvis
ENTRAN EGAS-FS-50	I.AD	036-1101	036-1251	I.AD & 036-1251	I.AO	I.AO
KYOWA ASM-200BA	I.AM	034-1201	036-1251	I.AM & 036-1251	I.AN	I.AN
ENDEVCO 7264-2000	I.AM	034-1201	036-1251	I.AM & 036-1251	I.AN	I.AN
ENDEVCO 7264A/B-2000	I.AD	036-1101	036-1251	I.AD & 036-1251	I.AO	I.AO
MSC 126M/CM	I.AM	034-1201	036-1251	I.AM & 036-1251	I.AN	I.AN

### Tri-axial: (Mount Reference)

Accelerometer Type	Location					
	Head Mount (only Uni-axial accels)	Head Mount for Uni-accel & DTS ARS sensor (Optional)	Head Mount for ATA ARS-06S sensor (optional)	Head Mount for Uni-accel & ATA ARS-06S sensor (optional)	Thorax	Pelvis
ENDEVCO 7264A-1500	Not Possible	Not Possible	Not Possible	Not Possible	Use Endevco Mount Base	Use Endevco Mount Base

I.AD



I.AM

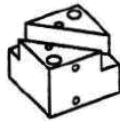

I.AO

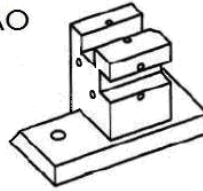

I.AN

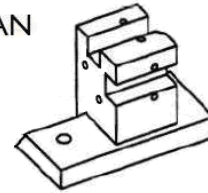

## Clothes / Misc.

Part Number	Description	Qty. Req'd Per Dummy
036-8000	Q1 SUIT	1
036-9900	USER MANUAL – Q1 DUMMY	1